

Ceiling Tile



CONTOUR®, HARMONI, WHITELINE® Ceiling Tiles or BIOLINE® Wood Ceiling Tiles Installation Instructions:

Installation Guide

- Fits any 15/16" grid systems.
- 9/16" and concealed grid tile options are available.
- Ceiling tiles simply drop into place.
- Press tiles from above to snap into grid; do not pull from face (CONTOUR and HARMONI).
- When retrofitting a current installation of 24" x 48" lay-in panels, you will need to install "cross-tees" to accommodate your 24" x 24" Ceiling Tiles.
- Installation is best done at the end of the construction project.
- For HARMONI installations, maintain

CONTOUR Tile Instructions for Adhesive Installation:

- Wear clean cotton/canvas gloves to handle tiles for installation.

CONTOUR Ceiling Tiles are available in two different versions: one with a backerboard for installation in a ceiling grid; the other without a backerboard for installation with adhesive directly to any wall or ceiling surface.

- Recommended adhesive is acouSTIC (part PA-02). Other adhesives may not be compatible with our foams and may emit a strong odor.
- Each 10.5-ounce tube of acouSTIC adhesive will install approximately 32 square feet of CONTOUR Tiles. Each tube fits into a standard caulking gun.
- Wear clean cotton or canvas gloves during installation. Latex gloves are NOT recommended.
- Cut adhesive tube end to produce a 1/4" bead.
- Make sure the surface to which you are applying the tiles is clean and free of dust or residue.

uniform temperature of minimum 60°F and minimum humidity of 40% prior to, during and after installation.

- First apply a 1/4" bead of adhesive around the entire perimeter of the tile approximately 1" away from the edge.
- Second, apply a 1/4" bead of adhesive from opposite corners through the center of the tile to create an "X".
- Press into place and hold for 5 seconds.
- Next, pull the tile away from the surface to allow the adhesive to become tacky. Then, gently but firmly, press the tile back into position.
- CAUTION: If you apply the adhesive too close to the edge it can squeeze out when the tile is pressed into place. If you apply the adhesive more than 1" away from the edge, the tile may not properly bond against the hanging surface.
- Installation is best done at the end of the construction project.

General Installation Notes:

- When cutting CONTOUR, HARMONI or WHITELINE tiles, best results are achieved when cutting is done from the back side.
- Be sure to lay tiles on a clean surface before cutting.
- For best results use a sharp razor or fixed-blade knife and metal straight-edge. (See below for SQUARELINE.) Cutting with a dulled blade can produce a rough, unsightly edge. The knife blade should be long and sharp enough to cut evenly through the entire thickness with a single measured stroke.
- BIOLINE should be cut using standard wood cutting tools such as a table saw.
- An electric carving knife is the perfect tool for cutting and trimming CONTOUR, HARMONI and WHITELINE.
- When making free-hand cuts to fit the tiles around an obstruction, it is usually better to undersize the cut, then test fit and trim off more of the tile as needed for an accurate fit.
- Store all cartons right side up and flat in a clean, dry area, enclosed and protected from the elements such as rain, snow, and excessive heat or cold.
- Do not sit on or stack any materials on top that could crush protective shipping cartons as this may cause damage to the product.
- Do not open shipping carton or remove ceiling tiles until ready to install.

- SQUARELINE Metal Ceiling Tiles

same direction.

SQUARELINE® Metal Ceiling Tile Instructions:

- simply drop into place.
- Fits any conventional gridsystems.
- Tiles notched for quick orientation. Install with notches facing in the
- Installation is best when done at the end of the construction project.

- Wear clean cotton or canvas gloves during installation. Latex gloves are NOT recommended.
- SQUARELINE trim tiles or WHITELINE Ceiling Tiles are ideal for the ceiling perimeter.
- When cutting SQUARELINE Metal

Ceiling tiles, best results are achieved when cutting is done with professional metal-cutting tools.

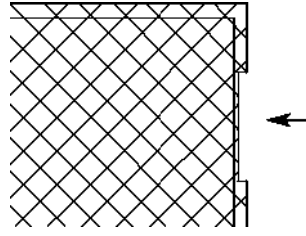

Separate install guides available for Panels, Baffles and Fabric Wall Panels.